

# Welcome

We look forward to meeting you and speaking with you about:

- The new Island Class ferries
- The new tie-up berth planned for Quathiaski Cove
- The Campbell River Terminal Development Plan

Please help yourself to refreshments, review the boards and talk with our team members about the exciting changes coming to your community.



# Tie-up Berth Plans



With the arrival of two ferries to the Campbell River – Quadra Island route, we will need a place to store the second ferry when it's not in use.

We have purchased the property at 733 Pidcock Road to house a night tie-up berth for a new second ferry.



# Rezoning and Regulatory Requirements



## Rezoning

We are seeking rezoning of three main areas in the Quadra Island Zoning Bylaw to Marine Commercial 1 (MC-1) to allow use of the land and water for ferry use.



## Amendment to Quadra Island Official Community Plan (OCP)

We are seeking a text change to the OCP that outlines a site-specific description and proposed use for this small piece of land and water.



## Regulatory Reviews and Approvals

In order to construct the new tie-up berth we must also go through a series of regulatory reviews and approvals that are now underway, including:

- Water lot lease acquisition
- Environmental assessments and approvals
- Archaeological assessments and permits

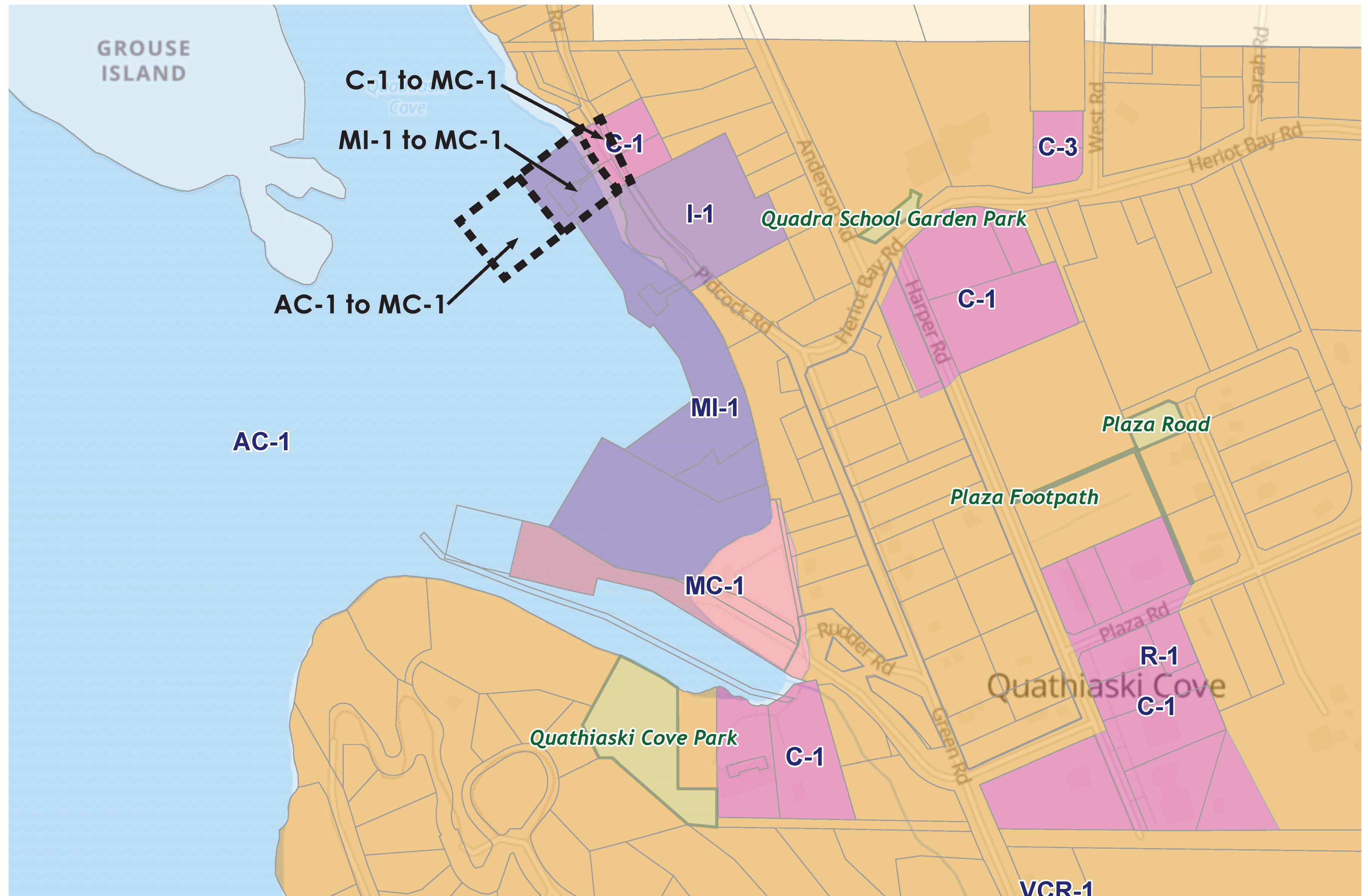



# Mitigating Impacts and Next Steps

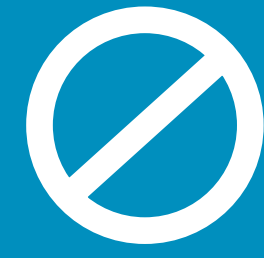

## There will be no:

- Vehicles on or off-loading at the berth
- Regular PA announcements
- Water or sewage pump off/on
- Fueling of ships



## Potential Construction Impacts

Some impacts may be felt by surrounding neighbours during construction including:

- Noise from trucks and construction activities (cutting, hammering etc.)
- Marine rig and drill noise
- Pile installation
- Visual disruption (clearing of trees and brush, craning and barging of supplies etc.)

We will continue to communicate with our neighbours to ensure they are aware of when work will take place and its expected length, as well as planned mitigation.

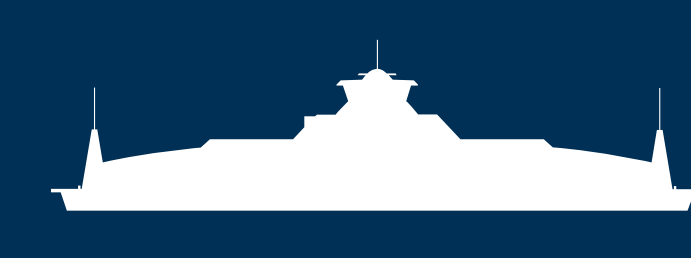

## Potential Daily Operational Impacts

The daily operations that occur at the tie-up berth will be minimal, but nearby neighbours may notice:

- Increased lighting at the site compared to what is there today
- Illumination from the ship when in berth at night (this will be minimized to the greatest extent possible)
- Some noise during ship arrival and departure, diesel-battery hybrid systems will help keep noise minimal

## Next steps

OCP amendments,  
water lot lease space,  
environmental &  
archaeological reviews



Completing detailed  
construction plans  
and timelines

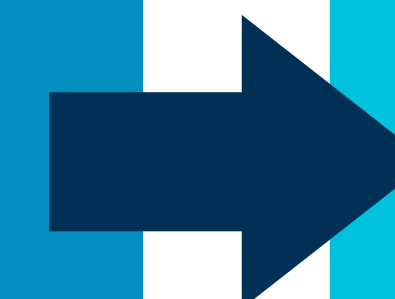

Communicating with  
neighbours and the Quadra  
Island community regarding  
construction plans and  
mitigation measures



# Island Class Key Features



Carries 47 vehicles and 300-450 passengers and crew depending on configuration



Battery-hybrid power systems improve efficiency and reduce emissions



Flexibility for full electric operation in the future



Twin propellers reduce underwater radiated noise



Completely outfitted with LED lighting

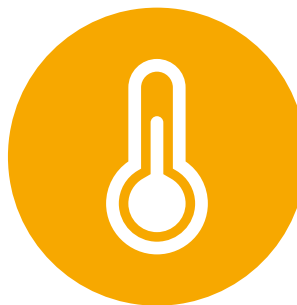

Heat recovery system uses waste thermal energy to heat vessel

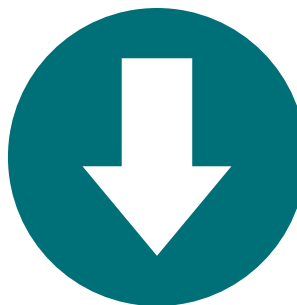

Low friction and biofouling resistant hull coating reduces fuel consumption



Exhaust system reduces NOx emissions through selective catalytic reduction



# Island Class Layout

## Main Deck

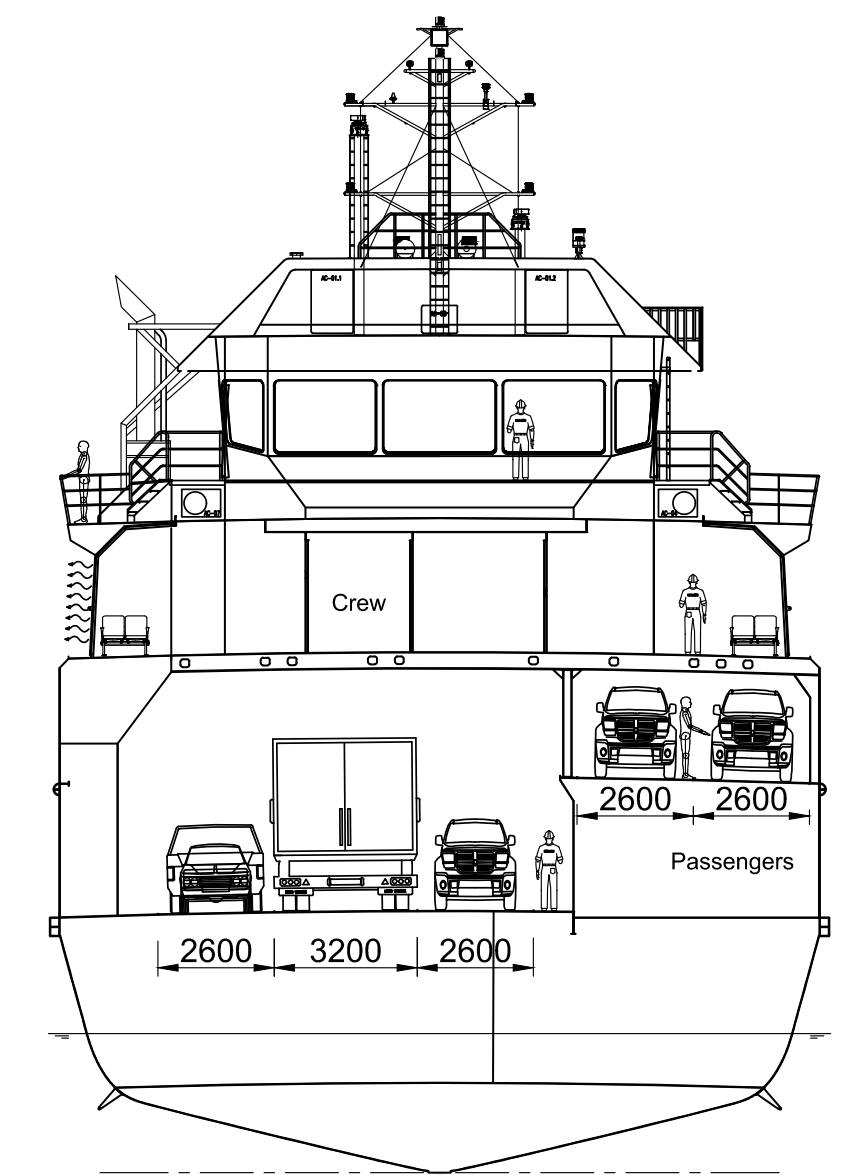
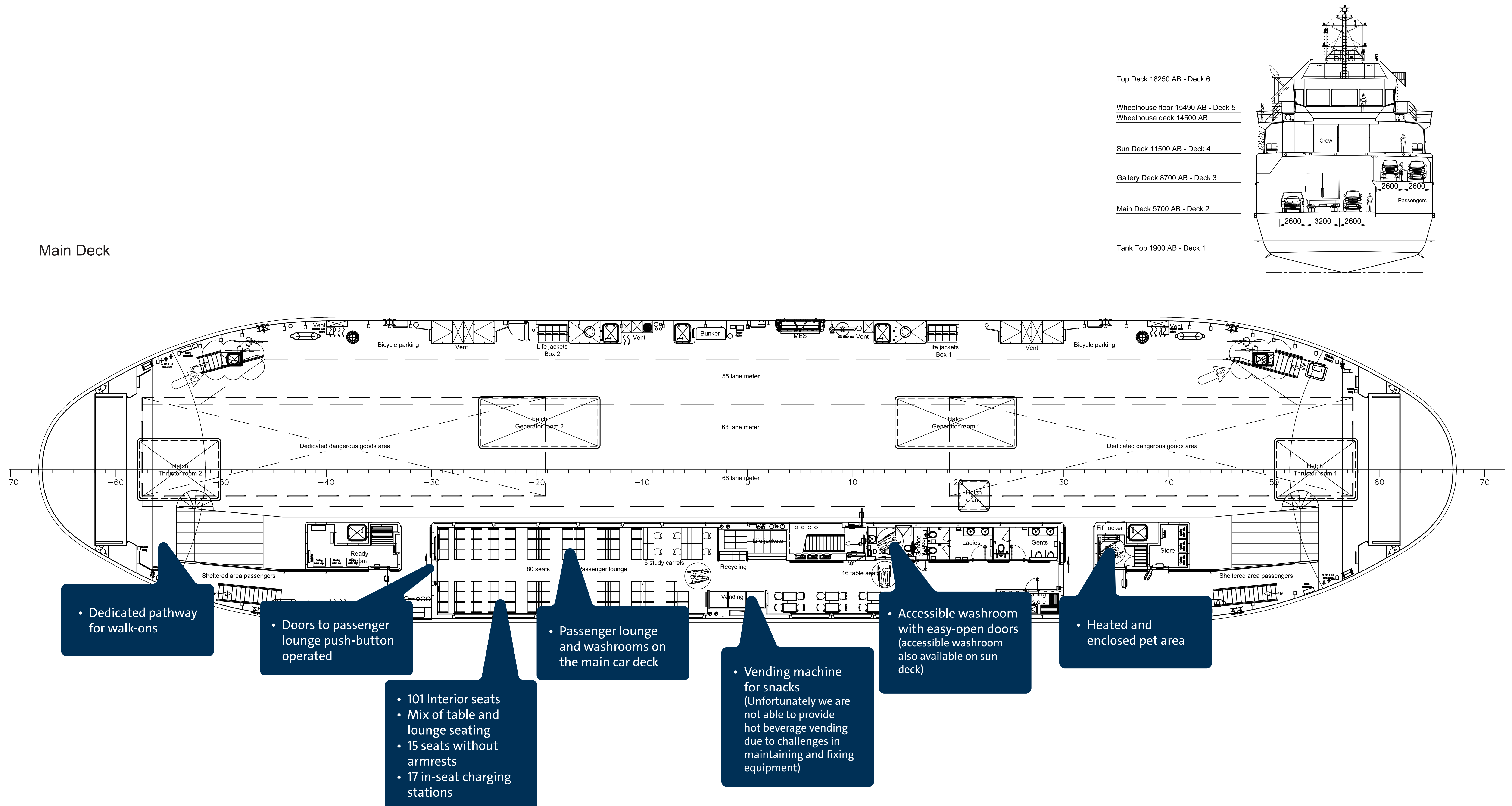



# Campbell River Terminal Development Plan

## Top 3 Themes

Improve

### FERRY TRAFFIC

(points of entry and exit, impacts of traffic back-ups on roadways, parking)



Improve

### PEDESTRIAN SAFETY

(pedestrian safety crossing highway, pedestrian accommodation in the terminal, pick-up/drop-off area)



Improve

### AMENITIES

(waiting room and washrooms, provide shade/shelter, food/beverage offerings)



## Timeline

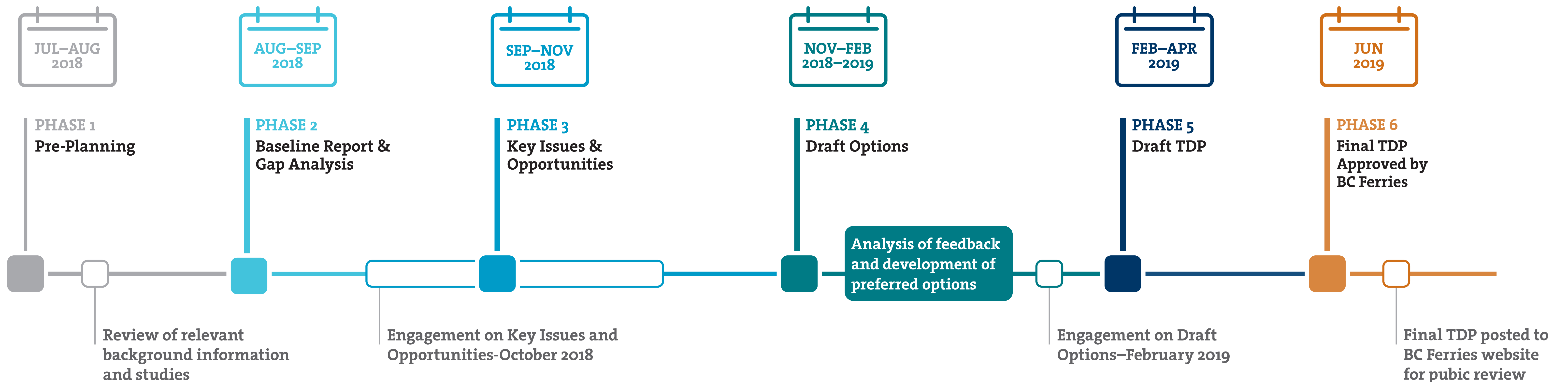



# Campbell River Terminal Development Plan | Illustrative Concept Plan

